

Miles Stair's Wick Shop

www.MilesStair.com
Quality Kerosene Items since 1999

- (1) Be sure to turn wick down firstly with the emergency shut-off button.
- (2) Remove the batteries from battery case located on the right side of the heater body.
- (3) Turn the top plate counter-clockwise and remove it from the cabinet. Then, take out the burner chimney. (picture 1)

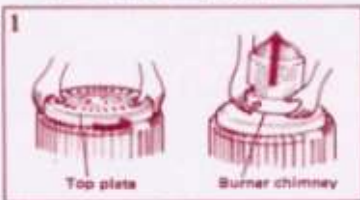

- (4) Remove the wick control knob by pulling it forward.
- (5) Remove 3 (three) screws with a coin or screwdriver from each side and back side of the cabinet respectively. Detach the cabinet by inclining it forward slightly and set it aside in a safe location. (picture 2)



- (6) Remove 4 (four) wing nuts located on the outer wick guide assembly and detach it taking care not to damage or disconnect the ignition wires. (picture 3)

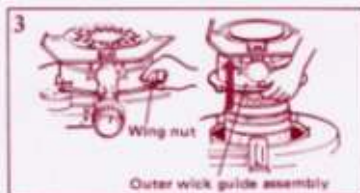

- (7) Place the wick control knob in place.
- (8) Make sure that the stopper is set properly as illustrated on a magnifying drawing of picture 4, then use one of the screws removed and put it into the hole tightly as shown in picture 4.
 - If the stopper is not in proper position, turn the ratchet clockwise by one cog. Then, put one screw into the hole tightly as instructed above.

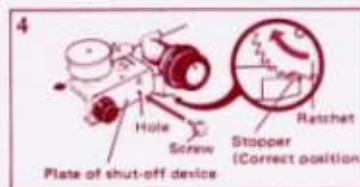

- (9) Remove the snap ring which locks the wick control shaft in place. (picture 5)

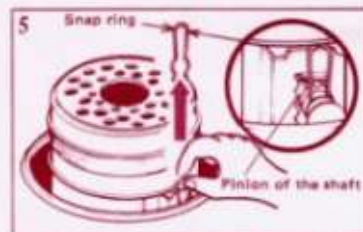

- (10) Detach the wick control shaft from the gear plate of the outer wick holder by pulling the wick control knob forward slightly. Then, take out the old wick assembly and dispose of it in a safe location. (picture 6)
 - The wick assembly consists of wick, inner and outer wick holders.

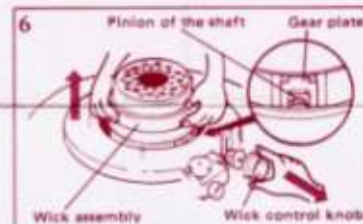

- (11) Put the new wick assembly in place by turning it right and left several times. Be sure that the gear plate of outer wick holder is to the front of the heater and also that the skirt of the wick is fully suspended in oil reservoir. (picture 7)

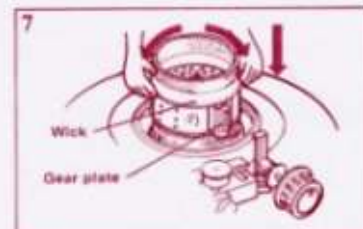

- (12) Let the new wick assembly down at lowest position.
- (13) Make sure that the convex stopper of the wick control shaft and the ratchet axis are in correct position (picture 8) and also that the pinion of the wick control shaft is put in the correct (upper) part of the gear plate.



- (14) Then, reengage the pinion of the wick control shaft with the gear plate by pushing the wick control knob forward. (picture 9)

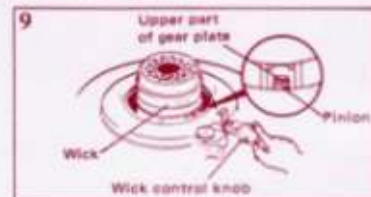

- (15) Place the snap ring firmly (picture 10). Make sure not to pull the wick control shaft.

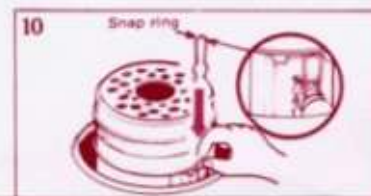

- (16) Remove the screw which was used to hold the ratchet and wick control shaft.
 - Do not touch the pendulum of the shut-off device to avoid any injury by ratchet moving.

- (17) Raise the wick to its full height by turning the wick control knob clockwise, then place the outer wick guide assembly taking care not to damage or disconnect the ignition wires. Make sure that wick goes up and down smoothly and also that the gap between the outer wick guide and the wick guide cylinder is equal at all points. To get correct gap, tighten 2 (two) wing nuts diagonally and simultaneously and then tighten the other 2 (two) wing nuts accordingly. (picture 11)



- (18) Turn the wick control knob clockwise until it stops and then use the emergency shut-off button to check that wick goes down correctly.

- (19) The heater can be reassembled by taking 5-1 steps in opposite way.

- After replacing new wick assembly, wait approximately 30 minutes before lighting the heater in order to allow the new wick to absorb sufficient kerosene.